

4

3

2

1

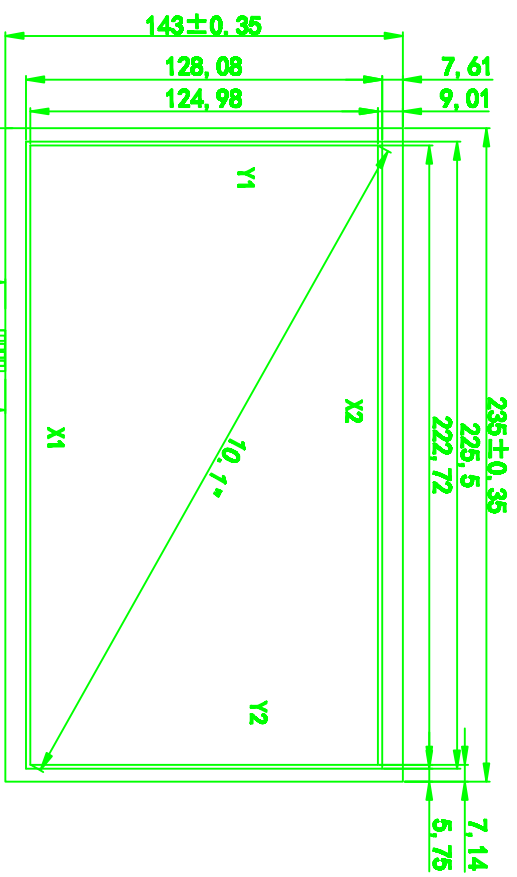
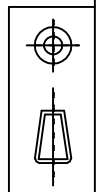

| PIN | OUT |
|-----|-----|
| 1 | Y1 |
| 2 | X1 |
| 3 | Y2 |
| 4 | X2 |

o.188mm ito film
1.1mm ito glass

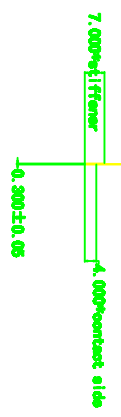

由 Autodesk 教育版产品制作

Notes:

1. Type: Film to Glass
2. Operating Voltage: $\leq 10V$
3. Operation Temperature: $-10^{\circ}C \sim 60^{\circ}C$ Storage Temperature: $-20^{\circ}C \sim 70^{\circ}C$
4. Life Time: $> 1,000,000$ times
5. Connect Material: FPC
6. Response Time: $\leq 10ms$
7. Linearity: $\leq 1.5\%$
8. Transmittance: $\geq 85\%$
9. Surface Hardness $\geq 3H$ (pencil)
10. Operation force: $60g \sim 150g$
11. Resistance: X: $200 \Omega - 1000 \Omega$ Y: $100 \Omega - 600 \Omega$

| | | | |
|-----------|-----------|------------|-----------|
| MODEL NO. | CJ101A4A1 | UNIT: | MM |
| DRAWN: | | TOLERANCE: | ± 0.3 |
| DATE: | 10/10/25 | SCALE: | 1:1 |
| VERSION: | 1.0 | REV: | |

4

3

2

1